

[See all 23 Products in Family](#)

**TECHSPEC® 0.08X GoldTL™ Telecentric Lens (Mount Included)**



0.06X GoldTL™ Telecentric Lens (Mount Included)



Stock #17-204 **4 In Stock**

- 1 + MRP ₹5,98,665

! Price inclusive of all taxes

**ADD TO CART**

Volume Pricing	
Qty 1+	₹5,98,665 each
Need More?	<a href="#">Request Quote</a>

Product Downloads

**General**

GoldTL™ Series **Product Family:**

#56-873, Included **Stock No. of Mounting Clamp:**

Telecentric Lens **Type:**

**Special Type of Lens:**

## Physical & Mechanical Properties

Variable	<b>Iris Option:</b>
277.28	<b>Length (mm):</b>
277.28	<b>Length excluding Threads (mm):</b>
160.00	<b>Maximum Diameter (mm):</b>

## Optical Properties

107.1mm	<b>Horizontal Field of View, 2/3" Sensor:</b>
87.5mm	<b>Horizontal Field of View, 1/1.8" Sensor:</b>
77.8mm	<b>Horizontal Field of View, 1/2" Sensor:</b>
11.00	<b>Maximum Image Circle (mm):</b>
0.0069	<b>Numerical Aperture NA, Object Side:</b>
70.6	<b>Resolution, Image Space MTF @ f/10:</b>
10 (6)	<b>Number of Elements (Groups):</b>
<0.0123	<b>Typical Telecentricity @ 588nm (°):</b>
0.038	<b>Typical Distortion @ 588nm (%):</b>
0.08X	<b>Primary Magnification PMAG:</b>
0.08	<b>Telecentric Lens Magnification:</b>
170-220	<b>Working Distance (mm):</b>
107.1 x 80.2	<b>FOV @ Max Sensor Format, H x V (mm):</b>
f/6-f/25	<b>Aperture (f/#):</b>
λ/4 MgF <sub>2</sub>	<b>Coating:</b>
± 80mm at f/10 (20% @ 20 lp/mm)	<b>Depth of Field (mm):</b>
0.08X	<b>Magnification:</b>
VIS	<b>Lens Wavelength Range:</b>

## Sensor

2/3"	<b>Maximum Sensor Format:</b>
2.74	<b>Pixel Size (µm):</b>

## Threading & Mounting

M154 x 1.50 (Female)	<b>Filter Thread:</b>
C-Mount	<b>Mount:</b>

## Regulatory Compliance

<a href="#">View</a>	<b>Certificate of Conformance:</b>
United States	<b>Country of Origin:</b>
Edmund Optics India Private Limited 267, Greystone Building, Second Floor, 6th Cross Rd, Binnamangala, Stage 1, Indiranagar, Bengaluru, Karnataka, India 560038 Phone: +91- 80-6845 0000	<b>Imported By:</b>

## Product Details

- High Resolution Telecentric Lens for Measurement and Gauging
- Up to 5 MegaPixels, 3.45 $\mu$ m Pixel Size Sensors
- Up to 2/3", C-Mount Telecentric Lens
- Magnification from 0.06X to 1X

TECHSPEC® GoldTL™ Telecentric Lenses were designed specifically for machine vision and metrology applications. The unique focusable design allows for working distance adjustment, while still providing <math><0.2^\circ</math> telecentricity. These lenses also feature high resolutions, low distortions, and are available for 1/2" or 2/3" sensors. TECHSPEC® GoldTL™ Telecentric Lenses have a front filter thread for easy integration of [color filters](#), [polarizers](#) or other mounted components. Both the iris and focusing adjustment positions can be fixed by set screws to remain secure in high vibration environments.

## Technical Information

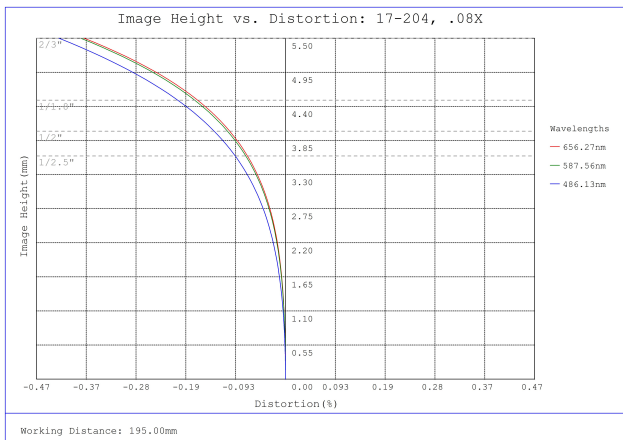

#17-204, 0.08X GoldTL™ Telecentric Lens (Mount Included), Distortion Plot

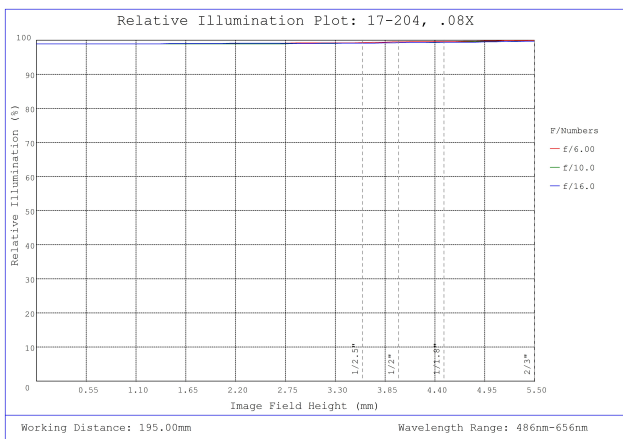

#17-204, 0.08X GoldTL™ Telecentric Lens (Mount Included), Relative Illumination Plot

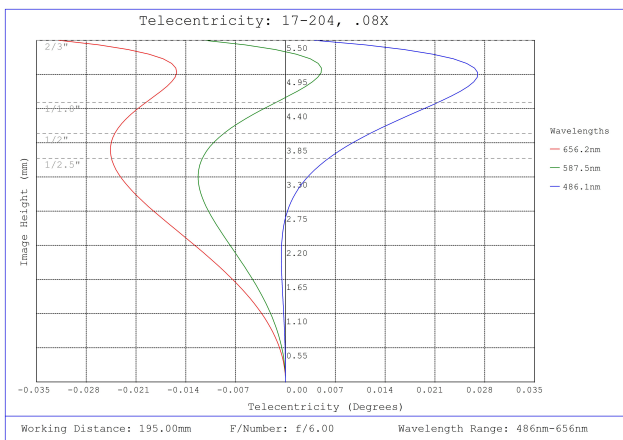

#17-204, 0.08X GoldTL™ Telecentric Lens (Mount Included), Telecentricity Plot

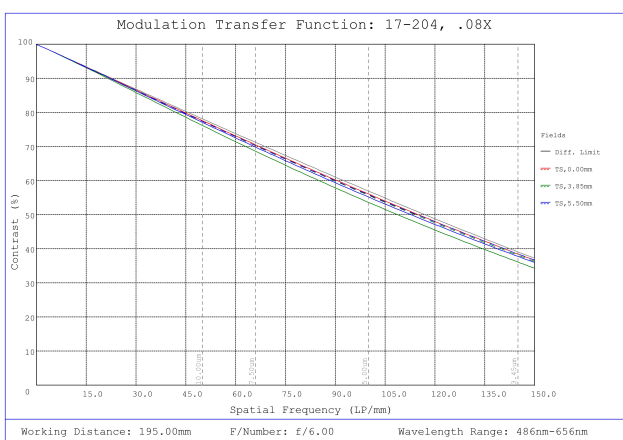

#17-204, 0.08X GoldTL™ Telecentric Lens (Mount Included), Modulated Transfer Function (MTF) Plot, 195mm Working Distance, f6

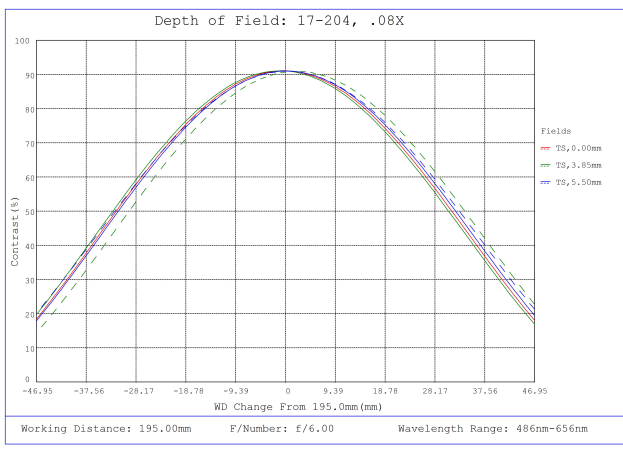

#17-204, 0.08X GoldTL™ Telecentric Lens (Mount Included), Depth of Field Plot, 195mm Working Distance, f6

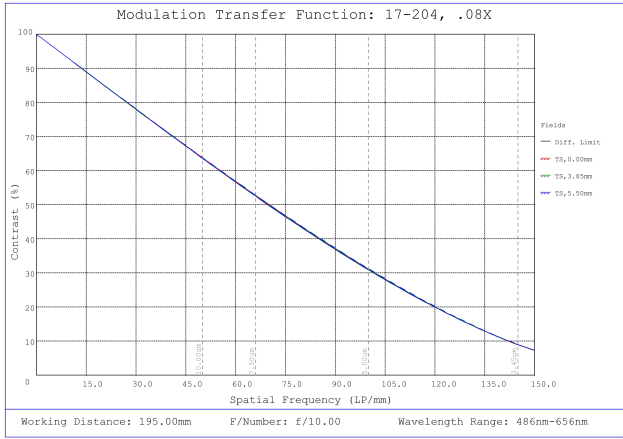

#17-204, 0.08X GoldTL™ Telecentric Lens (Mount Included), Modulated Transfer Function (MTF) Plot, 195mm Working Distance, f10

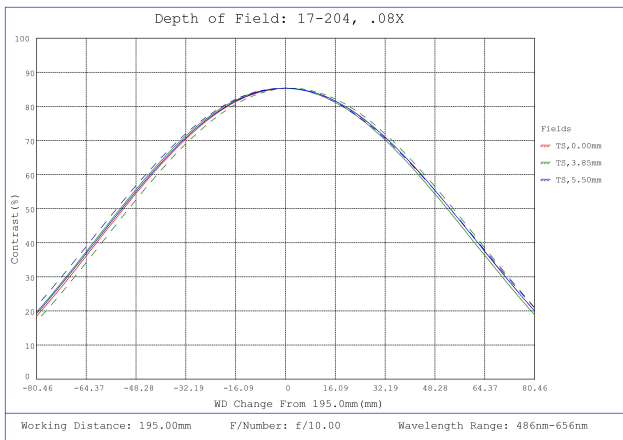

#17-204, 0.08X GoldTL™ Telecentric Lens (Mount Included), Depth of Field Plot, 195mm Working Distance, f10

Stock No.	A	B	C	D	E	F	G
#56-024	88mm	16mm	34mm	94mm	120mm	101.6mm	50mm
#56-025	85mm	17.5mm	32.5mm	91mm	120mm	101.6mm	48.5mm
#56-026	103mm	—	39.5mm	107mm	103mm	90mm	55.5mm
#56-027	134mm	—	55mm	148mm	134mm	122mm	81mm

**Telecentric Lens Mounts**

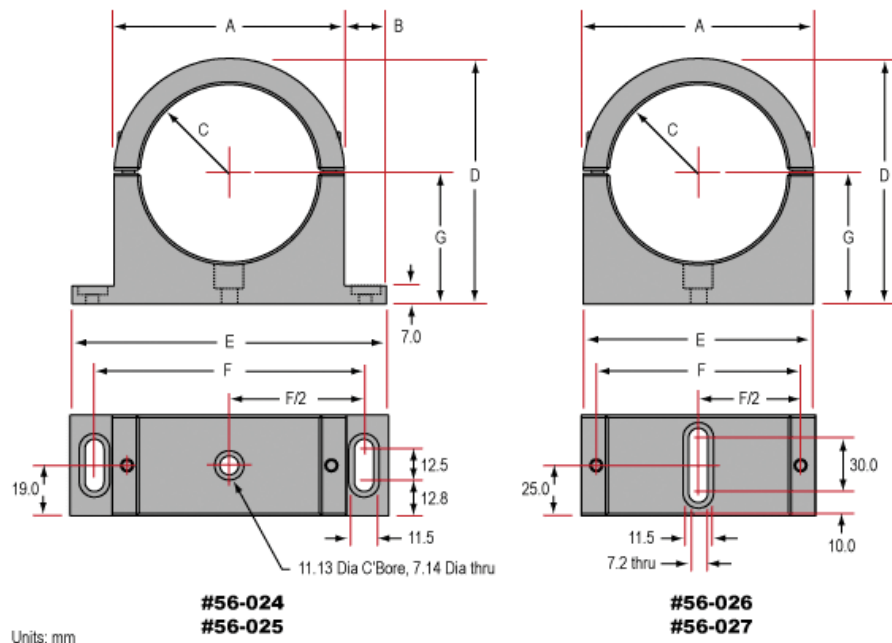

**Telecentric Lens Mount for #56-948**

