

[All Products](#) / [Optomechanics](#) / [Manual Translation Stages and Slides](#) / [Manual Stages and Slides](#)

# Heavy Load Capacity Rotary Positioning Stages



- Normal Load Capacity of 25lb (11.3kg) for heavy duty applications
- Precision Worm Gear Drive
- Compatible with Metric and English 5" Ball Stages

## Common Specifications

### Physical & Mechanical Properties

Type of Movement:	Rotary	Stage Size (mm):	120.7 x 120.7
Travel (°):	360	Construction:	Aluminum Top and Base; Steel/bronze Worm Gear Drive
Gear Drive Ratio:	120:1	Increments (arcmin):	6 (Vernier)

### Hardware & Interface Connectivity

Type of Drive:	Worm Gear
----------------	-----------

## Technical Information

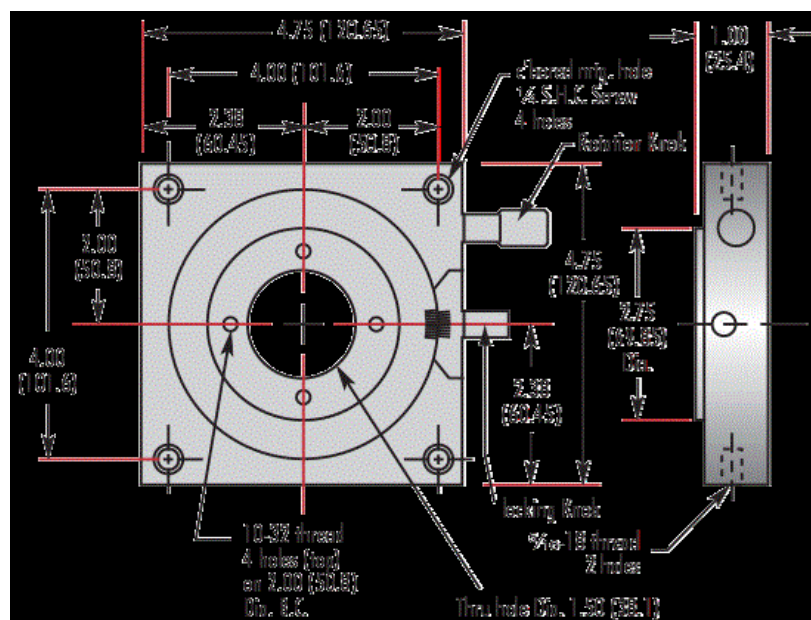

## Products

Stage Size (mm)	Type	Table Diameter (inches)	Table Diameter (mm)	Center Hole	Travel (°)	Stock Number	Price	Buy
120.7 x 120.7	English	2.75 (69.8mm)	-	1.5" Dia. Thru	360	<a href="#">#38-195</a>	₹83,619	10 to 12 days
<a href="#">#13-773 Clearance</a>								
								
Clearance								
Availability is limited, so buy before these products disappear. Sorry, we cannot accept returns. Receive up to 80% off select products.								
120.7 x 120.7	Metric	-	69.8	38.1mm Dia. Thru	360		₹1,02,600	10 to 12 days



Copyright 2023, Edmund Optics India Private Limited, #267, Greystone Building, Second Floor, 6th Cross Rd, Binnamangala, Stage 1, Indiranagar, Bengaluru, Karnataka, India 560038  
 Phone: 1-800-363-1992 : [www.edmundoptics.com](http://www.edmundoptics.com)