

- NOTES:
- 1. SUBSTRATE: FLOAT GLASS
 - 2. COATING (APPLY ACROSS CLEAR APERTURE)

S1 & S2: BBAR (425-700nm)
R(AVG) ≤0.5% @ 425 - 700nm

3. FINE GRIND SURFACE

4. ROHS COMPLIANT

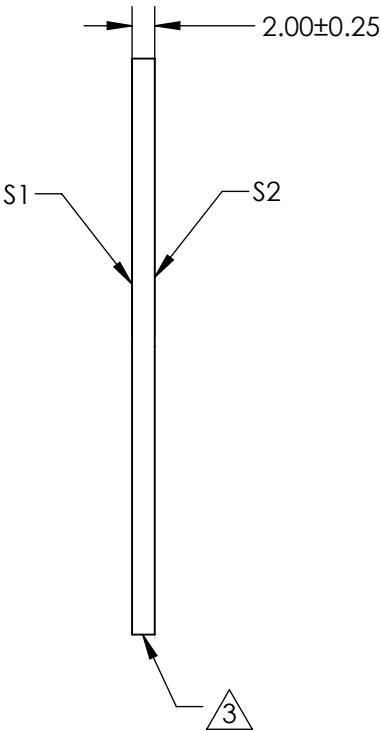
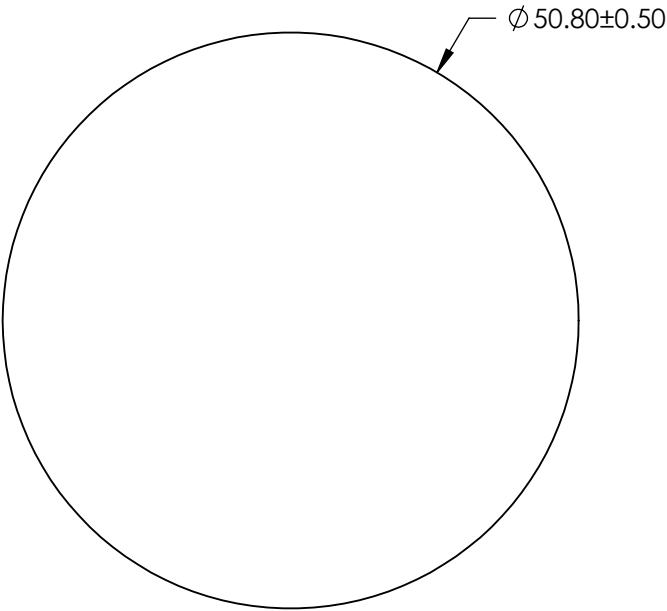

**FOR INFORMATION ONLY:
DO NOT MANUFACTURE
PARTS TO THIS DRAWING**

SPECIFICATIONS SUBJECT TO CHANGE WITHOUT NOTICE
DIMENSIONS ARE FOR REFERENCE ONLY

	S1	S2
SHAPE	PLANO	PLANO
SURFACE QUALITY	80 - 50	80 - 50
CLEAR APERTURE	$\phi 45.72$	$\phi 45.72$
BEVEL	PROTECTED AS NEEDED	PROTECTED AS NEEDED

THIRD ANGLE
PROJECTION

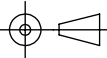

ALL DIMS IN

mm



Edmund Optics®

TITLE

50.8mm Dia. x 2mm High Efficiency Window

DWG NO

71593

SHEET
4 OF 7