

NOTES:

- 1. SUBSTRATE:  
ZERODUR®
- 2. SURFACE S2 TO BE PARALLEL WITH SURFACE S1 TO <3 ARCMIN
- 3. COATING (APPLY ACROSS CLEAR APERTURE)  
S1: Protected Aluminum (400-2000nm)  
R(avg) >85% @ 400 - 700nm  
R(avg) >90% @ 400 - 2000nm  
S2: NONE

4. ARROW ON EDGE POINTING TOWARD SURFACE S1

5. FINE GRIND SURFACE

6. ROHS COMPLIANT

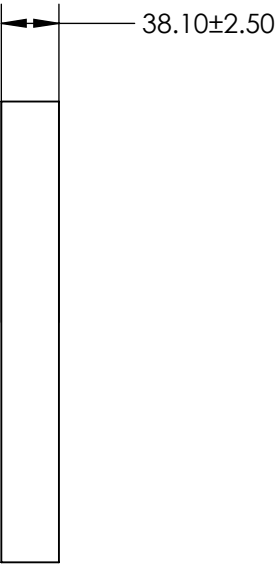
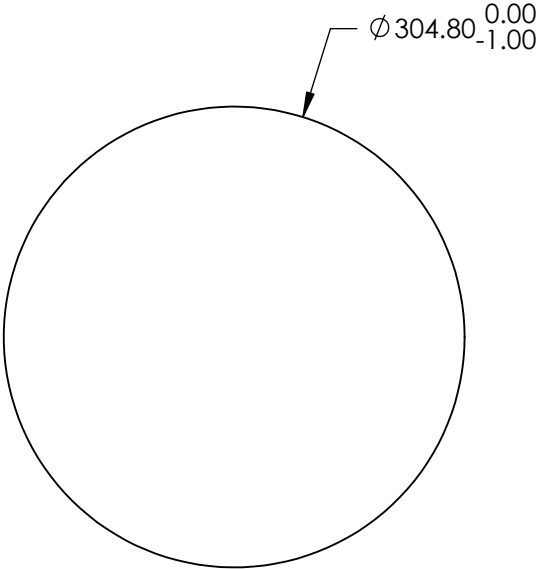
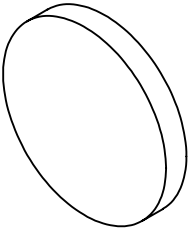

**FOR INFORMATION ONLY:  
DO NOT MANUFACTURE  
PARTS TO THIS DRAWING**

SPECIFICATIONS SUBJECT TO CHANGE WITHOUT NOTICE  
DIMENSIONS ARE FOR REFERENCE ONLY

	S1	S2
SHAPE	PLANO	PLANO
SURFACE FLATNESS	$\lambda/20$	N/A
SURFACE QUALITY	60-40	COMMERICAL POLISH
CLEAR APERTURE	$\varnothing 274.30$	$\varnothing 274.30$
BEVEL	PROTECTED AS NEEDED	PROTECTED AS NEEDED

**Edmund Optics®**

THIRD ANGLE  
PROJECTION



TITLE

12" Dia. Protected Aluminum,  $\lambda/20$  Flat  
ZERODUR®

ALL DIMS IN

mm

DWG NO

71111522

SHEET  
17 OF 20