

- NOTES:
- 1. SUBSTRATE:
FUSED SILICA
 - 2. COATING (APPLY ACROSS CLEAR APERTURE)
S1 & S2: NONE
 - 3. COMMERCIAL POLISH
 - 4. POWER, IRREGULARITY, AND SURFACE QUALITY
SPECIFICATIONS APPLY ACROSS CLEAR APERTURE
 - 5. ROHS COMPLIANT

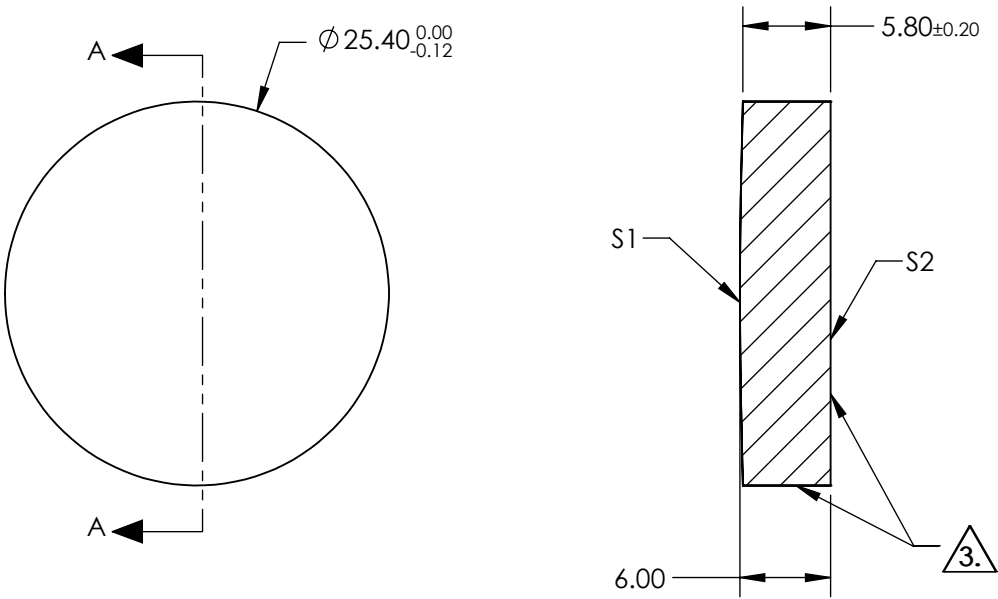

**FOR INFORMATION ONLY:
DO NOT MANUFACTURE
PARTS TO THIS DRAWING**

SPECIFICATIONS SUBJECT TO CHANGE WITHOUT NOTICE
DIMENSIONS ARE FOR REFERENCE ONLY

| | S1 | S2 | | | | |
|-------------------------|---------------------|---------------------|--|--|--|--|
| SHAPE | CONVEX | PLANO | | | | |
| RADIUS | 500 | INFINITY | | | | |
| SURFACE QUALITY | 20-10 | N/A | | | | |
| CLEAR APERTURE | Ø 22.86 | N/A | | | | |
| IRREGULARITY AT 632.8nm | λ/10 | N/A | | | | |
| BEVEL | PROTECTED AS NEEDED | PROTECTED AS NEEDED | | | | |

| | | | | | |
|------------------------|----|--------|-------|---|--|
| THIRD ANGLE PROJECTION | | TITLE | | 25.4mm Dia. x 500mm ROC, Uncoated, Convex Laser Mirror | |
| ALL DIMS IN | mm | DWG NO | 27636 | | |
| | | | | SHEET 15 OF 27 | |

Edmund Optics®