

- NOTES:
- 1. SUBSTRATE:
N-BK7
 - 2. CENTERING TOLERANCE (AT 587.6nm):
BEAM DEVIATION (HALF ANGLE): <3 ARCMIN
 - 3. COATING (APPLY ACROSS CLEAR APERTURE)
S1 & S2: NONE
 - 4. FINE GRIND SURFACE
 - 6. POWER, IRREGULARITY, AND SURFACE QUALITY
SPECIFICATIONS APPLY ACROSS CLEAR APERTURE
 - 7. ROHS COMPLIANT

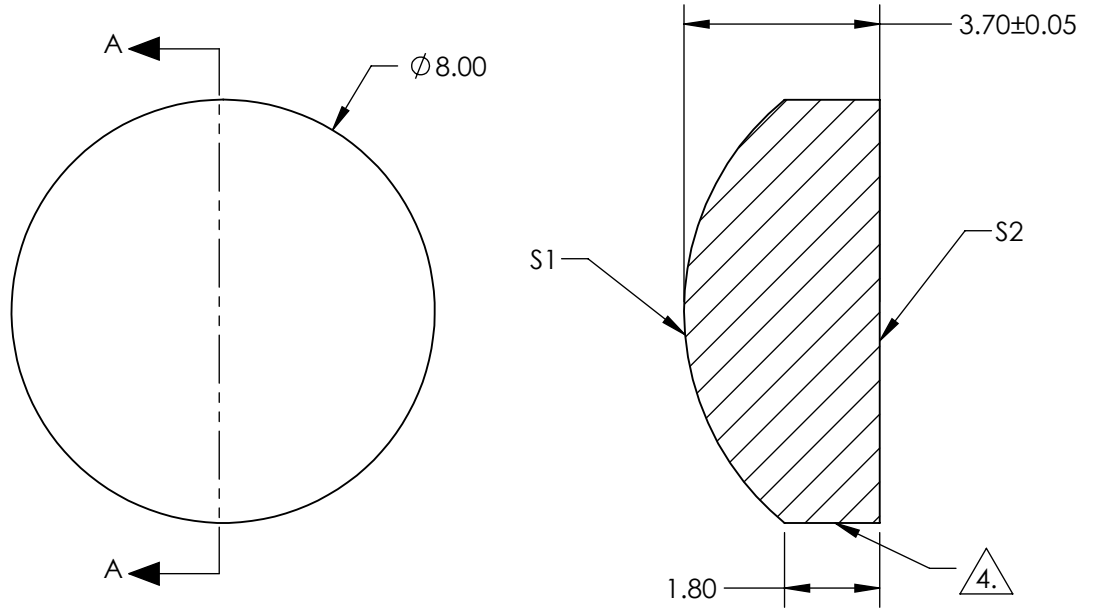

**FOR INFORMATION ONLY:
DO NOT MANUFACTURE
PARTS TO THIS DRAWING**

	S1	S2
SHAPE	CONVEX	PLANO
RADIUS	5.17	INFINITY
SURFACE QUALITY	40-20	40-20
CLEAR APERTURE	Ø 7.2	Ø 7.2
IRREGULARITY AT 632.8nm	λ/4	N/A
POWER AT 632.8nm	1.5λ	1.5λ
BEVEL	PROTECTED AS NEEDED	PROTECTED AS NEEDED

SPECIFICATIONS SUBJECT TO CHANGE WITHOUT NOTICE
DIMENSIONS ARE FOR REFERENCE ONLY

EO® Edmund Optics®

THIRD ANGLE PROJECTION		TITLE	8.0mm Dia. x 10.0mm FL, Uncoated, Plano-Convex Lens	
ALL DIMS IN	mm	DWG NO	28953	SHEET 24 OF 27