

- NOTES:
- 1. SUBSTRATE:
Zinc Selenide (ZnSe), CVD Grade
 - 2. CENTERING TOLERANCE:
EDGE THICKNESS VARIATION: <25µm
 - 3. COATING (APPLY ACROSS CLEAR APERTURE)

S1&S2: R(AVG) <4.5% @ 1 - 12µm
R(ABS) <8% @ 1 - 12µm

4. FINE GRIND SURFACE

5. SURFACE ROUGHNESS: <100 Ra

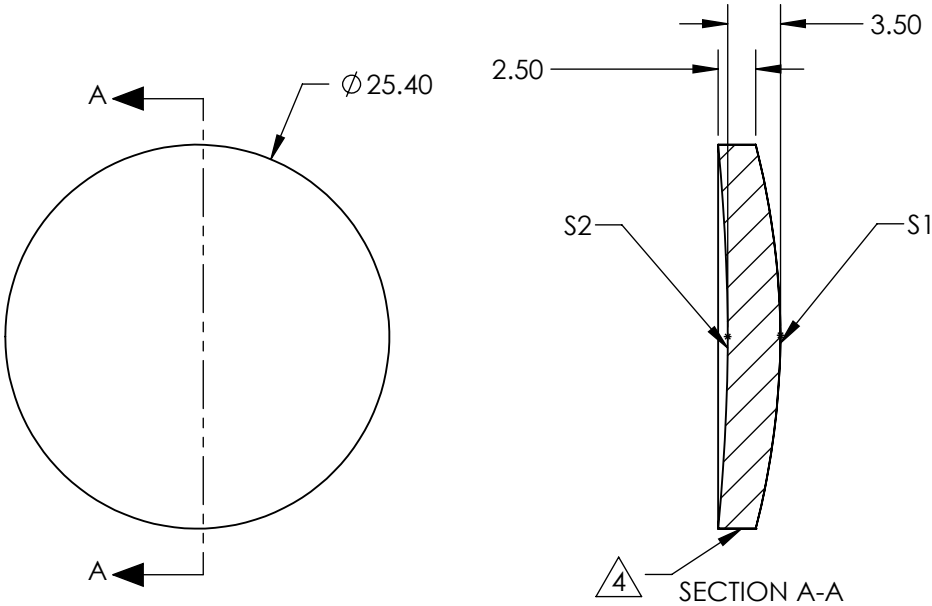

**FOR INFORMATION ONLY:
DO NOT MANUFACTURE
PARTS TO THIS DRAWING**

SPECIFICATIONS SUBJECT TO CHANGE WITHOUT NOTICE
DIMENSIONS ARE FOR REFERENCE ONLY

	S1	S2
SHAPE	CONVEX	CONCAVE
RADIUS	53.7711	127.3383
SURFACE QUALITY	60-40	60-40
CLEAR APERTURE	ø22.86	ø22.86
IRREGULARITY AT 632.8nm	λ/2	λ/2
BEVEL	PROTECTED AS NEEDED	PROTECTED AS NEEDED



ALL DIMS IN

mm



Edmund Optics®

TITLE

25.4mm Dia. x 63.5mm FL, 1 - 12µm BBAR
Coated, ISP Optics ZnSe Aspheric Lens

DWG NO

24972

SHEET
11 OF 19