

- NOTES:
- 1. SUBSTRATE:
Silicon (Si)
 - 2. CENTERING TOLERANCE:
EDGE THICKNESS VARIATION: <20µm
 - 3. COATING (APPLY ACROSS CLEAR APERTURE)

S1&S2: NONE

4. FINE GRIND SURFACE

5. SURFACE ROUGHNESS: <100 Ra

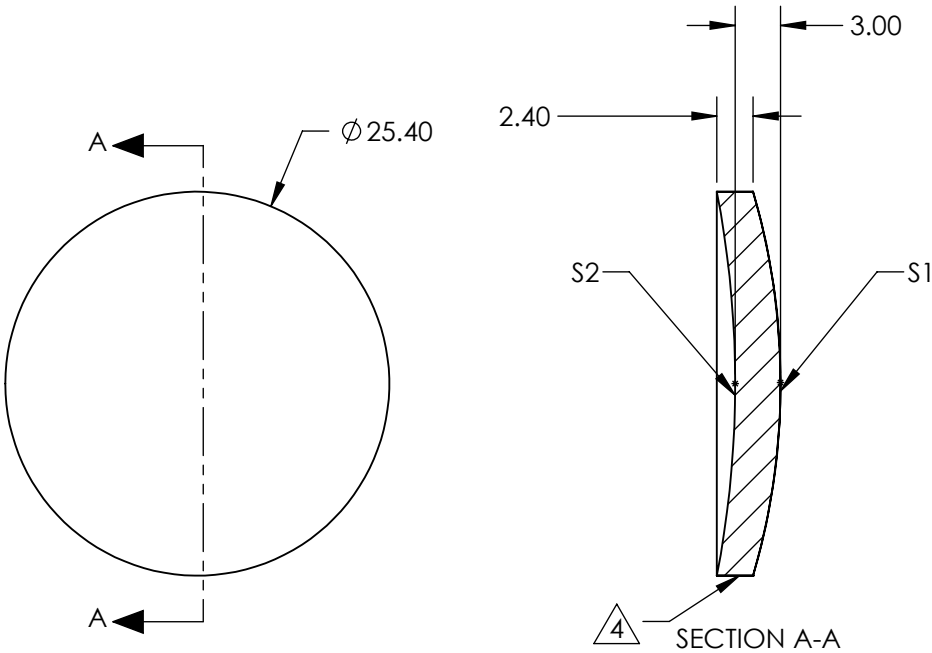

**FOR INFORMATION ONLY:
DO NOT MANUFACTURE
PARTS TO THIS DRAWING**

SPECIFICATIONS SUBJECT TO CHANGE WITHOUT NOTICE
DIMENSIONS ARE FOR REFERENCE ONLY

	S1	S2
SHAPE	CONVEX	CONCAVE
RADIUS	44.82	67.12
SURFACE QUALITY	60-40	60-40
CLEAR APERTURE	ø22.86	ø22.86
IRREGULARITY AT 632.8nm	λ/4	λ/4
BEVEL	PROTECTED AS NEEDED	PROTECTED AS NEEDED



ALL DIMS IN

mm



Edmund Optics®

TITLE

25.4mm Dia. x 50.8mm FL, Uncoated, ISP
Optics Silicon (Si) Aspheric Lens

DWG NO

24883

SHEET
3 OF 19