

NOTES:

- 1. SUBSTRATE: N-BK7
- 2. S2 TO BE PARALLEL WITH S1 TO <1 ARCMIN
- 2. COATING (APPLY ACROSS CLEAR APERTURE)

S1&S2: R(ABS) ≤1.5% @ 750 - 800nm  
R(ABS) ≤1.0% @ 800 - 1550nm  
R(ABS) ≤0.7% @ 750 - 1550nm

4. FINE GRIND SURFACE

- 5. ROHS COMPLIANT

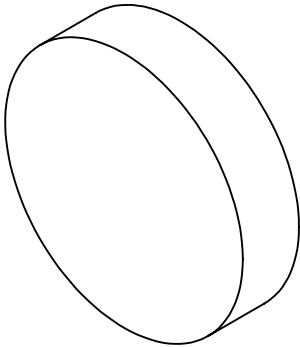

Ø 12.70<sup>0.00</sup><sub>-0.25</sub>

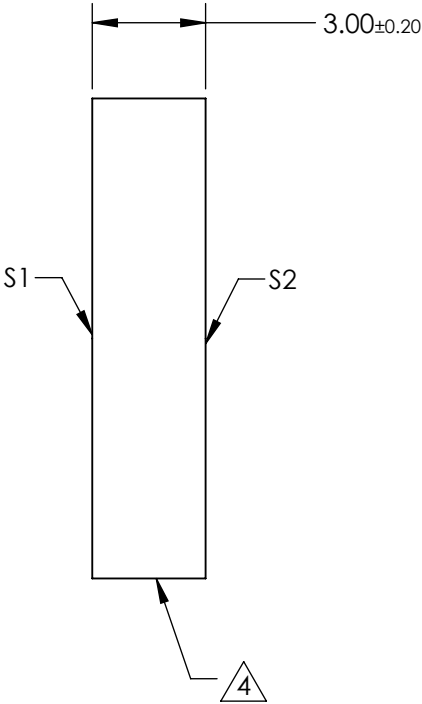
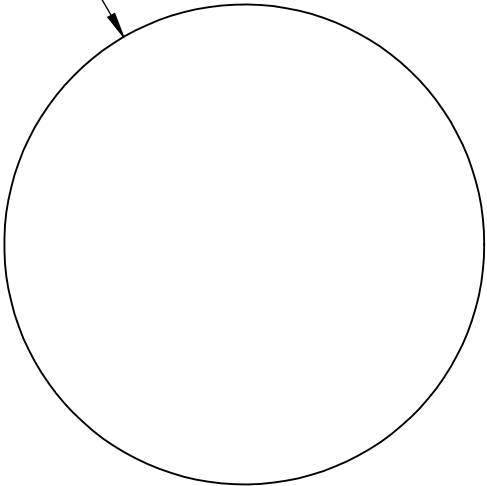

**FOR INFORMATION ONLY:  
DO NOT MANUFACTURE  
PARTS TO THIS DRAWING**

SPECIFICATIONS SUBJECT TO CHANGE WITHOUT NOTICE  
DIMENSIONS ARE FOR REFERENCE ONLY

|                 | S1                  | S2                  |
|-----------------|---------------------|---------------------|
| SHAPE           | PLANO               | PLANO               |
| SURFACE QUALITY | 60 - 40             | 60 - 40             |
| CLEAR APERTURE  | Ø 11.43             | Ø 11.43             |
| BEVEL           | PROTECTED AS NEEDED | PROTECTED AS NEEDED |

THIRD ANGLE  
PROJECTION

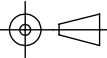

ALL DIMS IN

mm



Edmund Optics®

TITLE

12.7mm Dia., 3mm Thick, NIR II Coated λ/4 N-BK7 Window

DWG NO

25795

SHEET  
10 OF 36