

NOTES:

1. SUBSTRATE:

Zinc Selenide (ZnSe), CVD Grade

2. CENTERING TOLERANCE:

<3 ARCMIN

3. COATING (APPLY ACROSS CLEAR APERTURE)

S1 & S2: NONE



FINE GRIND SURFACE

5. FOCAL LENGTH TOLERANCE: $\pm 2\%$

6. ROHS COMPLIANT

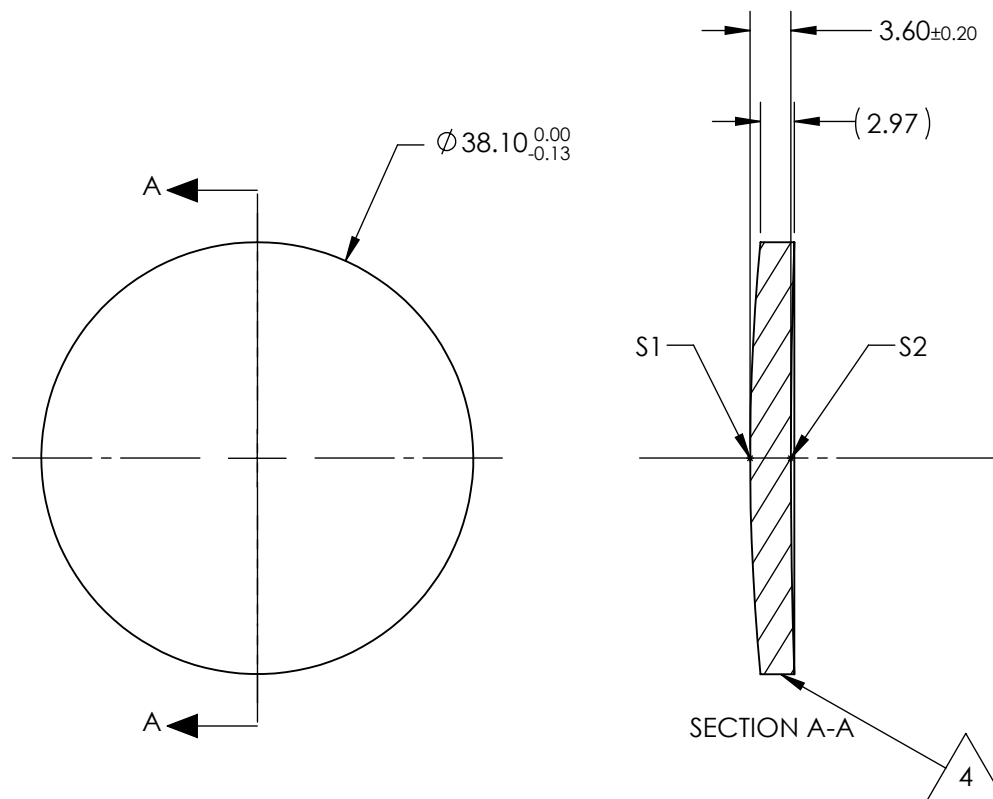

**FOR INFORMATION ONLY:
DO NOT MANUFACTURE
PARTS TO THIS DRAWING**

	S1	S2
SHAPE	CONVEX	CONCAVE
RADIUS	199.07	633.9
IRREGULARITY AT 10.6µm	$\lambda/20$	$\lambda/20$
SURFACE QUALITY	60-40	60-40
CLEAR APERTURE	ø34.29	ø34.29
BEVEL	PROTECTED AS NEEDED	PROTECTED AS NEEDED

EFL @ 10.6µm	203
BFL @ 10.6µm	203.73
THIRD ANGLE PROJECTION	
ALL DIMS IN	mm

SPECIFICATIONS SUBJECT TO CHANGE WITHOUT NOTICE
DIMENSIONS ARE FOR REFERENCE ONLY



Edmund Optics®

38.1mm Dia. x 203mm FL, Uncoated, ISP
Optics Zinc Selenide (ZnSe) Meniscus Lens

TITLE

DWG NO

24923

SHEET
1 OF 1