

- NOTES:
- 1. SUBSTRATE:
Zinc Selenide (ZnSe), CVD Grade
 - 2. CENTERING TOLERANCE:
<3 ARCMIN
 - 3. COATING (APPLY ACROSS CLEAR APERTURE)
S1 & S2: NONE
 - 4. FINE GRIND SURFACE
 - 5. FOCAL LENGTH TOLERANCE: ±2%
 - 6. ROHS COMPLIANT

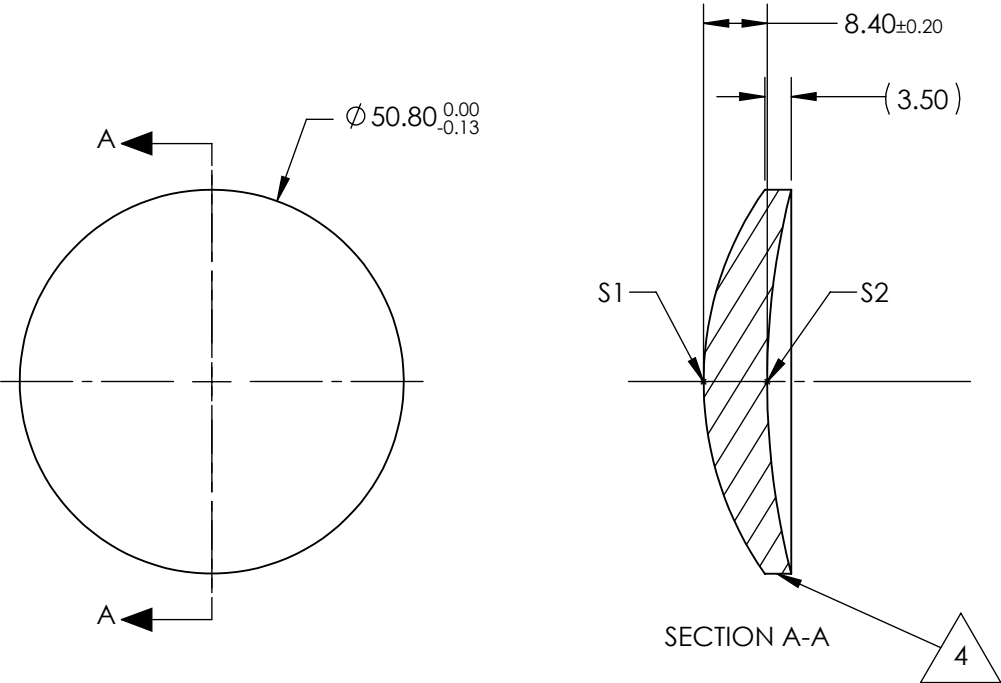

**FOR INFORMATION ONLY:
DO NOT MANUFACTURE
PARTS TO THIS DRAWING**

	S1	S2
SHAPE	CONVEX	CONCAVE
RADIUS	43.95	103.05
IRREGULARITY AT 10.6µm	λ/20	λ/20
SURFACE QUALITY	60-40	60-40
CLEAR APERTURE	ø45.72	ø45.72
BEVEL	PROTECTED AS NEEDED	PROTECTED AS NEEDED

EFL @ 10.6µm	50.8
BFL @ 10.6µm	44.82
THIRD ANGLE PROJECTION	
ALL DIMS IN	mm

SPECIFICATIONS SUBJECT TO CHANGE WITHOUT NOTICE
DIMENSIONS ARE FOR REFERENCE ONLY

Edmund Optics®

50.8mm Dia. x 50.8mm FL, Uncoated, ISP
Optics Zinc Selenide (ZnSe) Meniscus Lens

TITLE

DWG NO

24924

SHEET
1 OF 1