

NOTES:

1. SUBSTRATE:

Germanium (Ge)

2. CENTERING TOLERANCE:

<3 ARCMIN

3. COATING (APPLY ACROSS CLEAR APERTURE)

S1 & S2: NONE



FINE GRIND SURFACE

5. FOCAL LENGTH TOLERANCE:  $\pm 2\%$

6. ROHS COMPLIANT

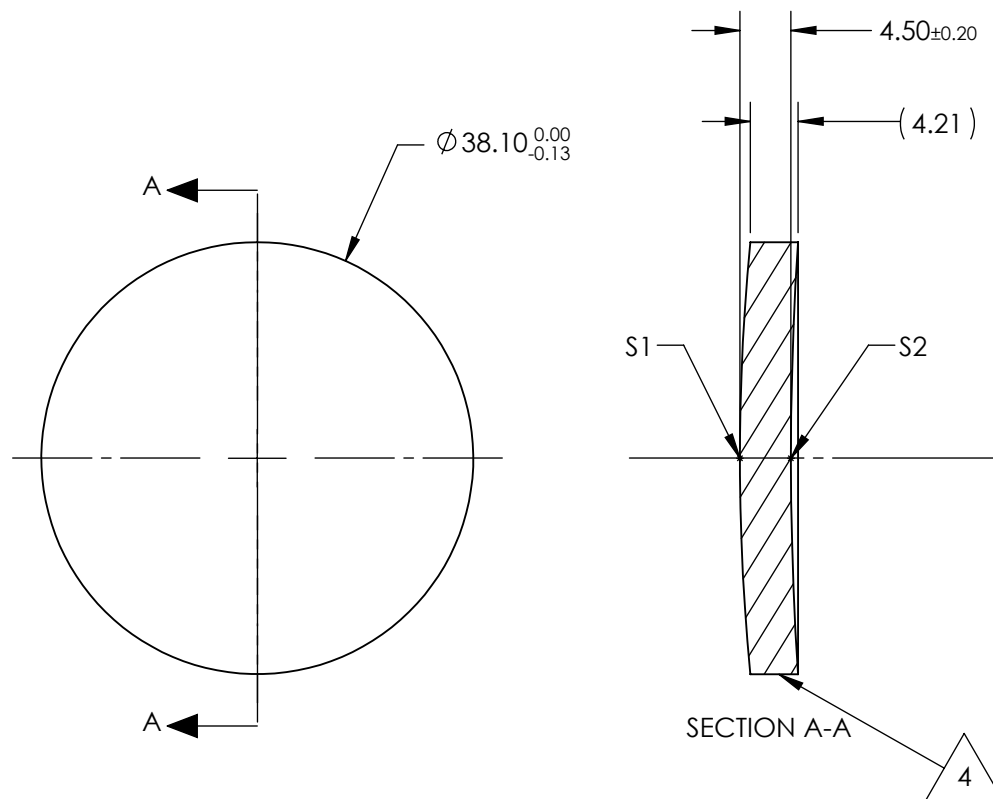

**FOR INFORMATION ONLY:  
DO NOT MANUFACTURE  
PARTS TO THIS DRAWING**

	S1	S2
SHAPE	CONVEX	CONCAVE
RADIUS	199.07	290.4
IRREGULARITY AT 10.6 $\mu$ m	$\lambda/20$	$\lambda/20$
SURFACE QUALITY	60-40	60-40
CLEAR APERTURE	$\varnothing 34.29$	$\varnothing 34.29$
BEVEL	PROTECTED AS NEEDED	PROTECTED AS NEEDED

EFL @ 10.6 $\mu$ m	200
BFL @ 10.6 $\mu$ m	199.76
THIRD ANGLE PROJECTION	
ALL DIMS IN	mm

SPECIFICATIONS SUBJECT TO CHANGE WITHOUT NOTICE  
DIMENSIONS ARE FOR REFERENCE ONLY



**Edmund Optics®**

38.1mm Dia. x 200mm FL, Uncoated, ISP  
Optics Germanium (Ge) Meniscus Lens

TITLE

DWG NO

24836

SHEET  
1 OF 1