

NOTES:

1. SUBSTRATE:  
Calcium Fluoride, IR Grade (CaF<sub>2</sub>)
2. CENTERING TOLERANCE:  
<3 ARCMIN
3. COATING (APPLY ACROSS CLEAR APERTURE)  
S1 & S2: NONE
4.  FINE GRIND SURFACE
5. FOCAL LENGTH TOLERANCE: ±2%
6. ROHS COMPLIANT

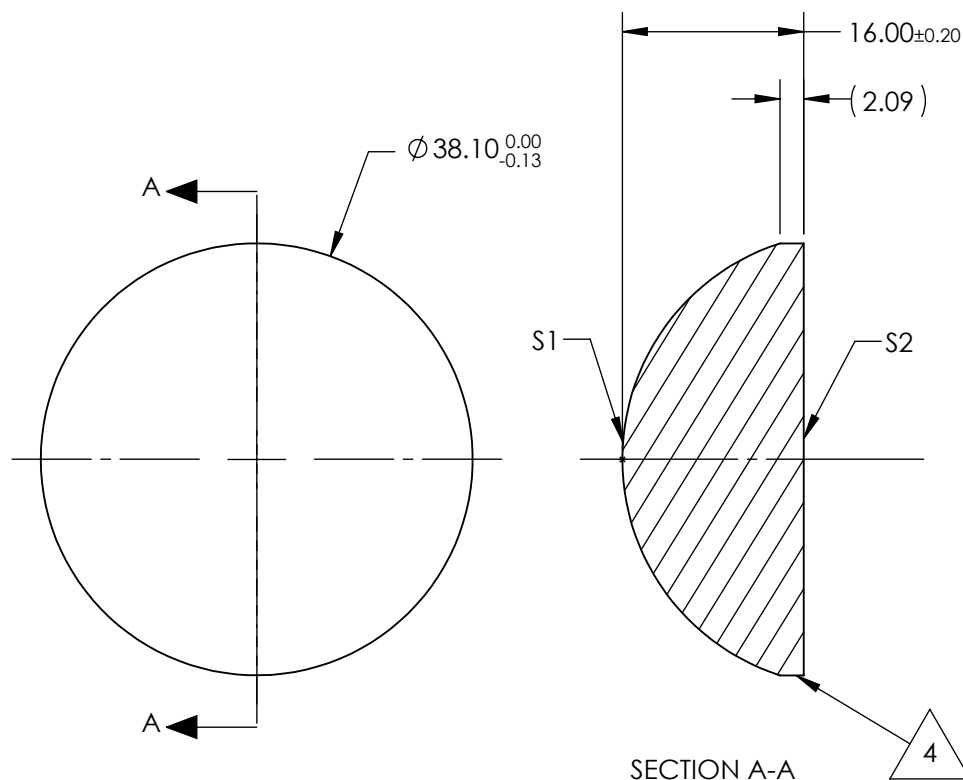

**FOR INFORMATION ONLY:  
DO NOT MANUFACTURE  
PARTS TO THIS DRAWING**

SPECIFICATIONS SUBJECT TO CHANGE WITHOUT NOTICE  
DIMENSIONS ARE FOR REFERENCE ONLY

	S1	S2	EFL @ 5μm	50.0	 Edmund Optics®		
SHAPE	CONVEX	PLANO	BFL @ 5μm	38.69			
RADIUS	20	INFINITY					
IRREGULARITY AT 632.8nm	λ	λ			TITLE	38.1mm Dia. x 50.8mm FL, Uncoated, ISP Optics Calcium Fluoride (CaF2) PCX Lens	
SURFACE QUALITY	60-40	60-40					
CLEAR APERTURE	ø34.29	ø34.29					
BEVEL	PROTECTED AS NEEDED	PROTECTED AS NEEDED	ALL DIMS IN	mm	DWG NO	24804	SHEET 1 OF 1