

NOTES:

1. SUBSTRATE:  
Calcium Fluoride, IR Grade (CaF<sub>2</sub>)
2. CENTERING TOLERANCE:  
<3 ARCMIN
3. COATING (APPLY ACROSS CLEAR APERTURE)  
S1 & S2: NONE
4.  FINE GRIND SURFACE
5. FOCAL LENGTH TOLERANCE: ±2%
6. ROHS COMPLIANT

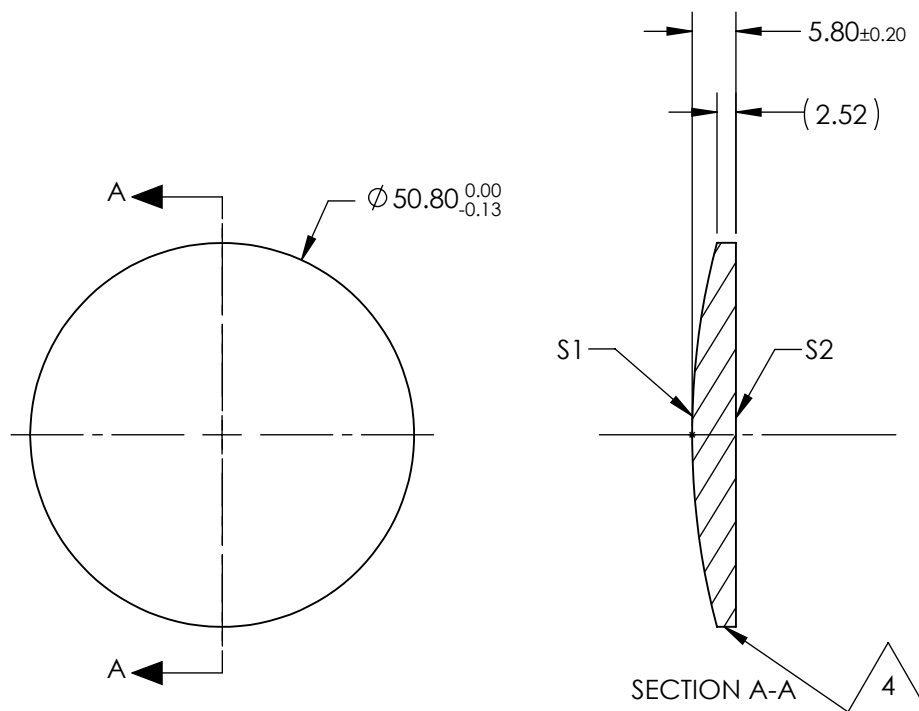

**FOR INFORMATION ONLY:  
DO NOT MANUFACTURE  
PARTS TO THIS DRAWING**

SPECIFICATIONS SUBJECT TO CHANGE WITHOUT NOTICE  
DIMENSIONS ARE FOR REFERENCE ONLY

			EFL @ 5µm		250.0		DIMENSIONS ARE FOR REFERENCE ONLY	
SHAPE	S1	S2	BFL @ 5µm		246.51		 Edmund Optics®	
RADIUS	CONVEX	PLANO						
IRREGULARITY AT 632.8nm	100	INFINITY						
	λ	λ						
SURFACE QUALITY	60-40	60-40	THIRD ANGLE PROJECTION 		TITLE		50.8mm Dia. x 250mm FL, Uncoated, ISP Optics Calcium Fluoride (CaF2) PCX Lens	
CLEAR APERTURE	ø45.72	ø45.72						
BEVEL	PROTECTED AS NEEDED	PROTECTED AS NEEDED	ALL DIMS IN	mm	DWG NO	24817	SHEET 1 OF 1	