

- NOTES:
- 1. SUBSTRATE: FUSED SILICA
 - 2. RoHS: COMPLIANT
 - 3. SURFACE S2 TO BE PARALLEL TO SURFACE S1 TO WITHIN <5 ARCMIN
 - 4. COATING (APPLY ACROSS CLEAR APERTURE)
S1 & S2: Ravg <0.5% @ 350 - 700nm

5. FINE GRIND SURFACE

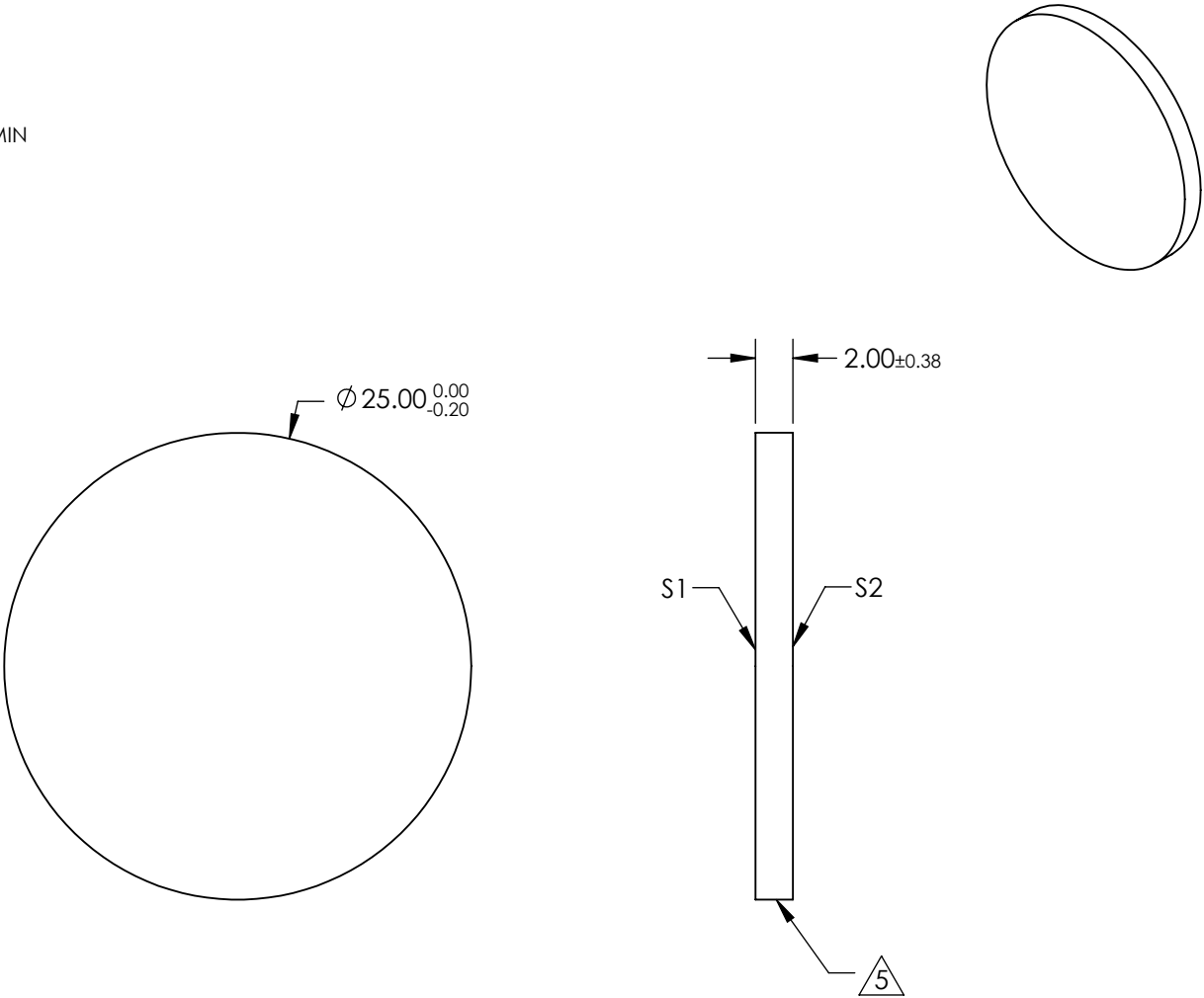

**FOR INFORMATION ONLY:
DO NOT MANUFACTURE
PARTS TO THIS DRAWING**

SPECIFICATIONS SUBJECT TO CHANGE WITHOUT NOTICE
DIMENSIONS ARE FOR REFERENCE ONLY

	S1	S2	<div><div><div><div><div></div><div></div></div></div><div>THIRD ANGLE PROJECTION</div></div><div><div>ALL DIMS IN</div><div>mm</div></div></div> <div><div><div><div></div><div></div></div></div><div><div>Edmund Optics®</div><div>25mm Dia. 2mm Thick VIS-EXT Coated, 1λ Fused Silica Widow</div></div></div> <div><div>DWG NO</div><div>25195</div></div> <div><div>SHEET</div><div>10 OF 52</div></div>			
SHAPE	PLANO	PLANO				
SURFACE ACCURACY	1λ	1λ				
SURFACE QUALITY	60 - 40	60 - 40				
CLEAR APERTURE	Ø 22.5	Ø 22.5				
BEVEL	PROTECTED AS NEEDED	PROTECTED AS NEEDED				