

NOTES:

1. REMOVABLE LEVER: M1.7 x 0.35 THREAD

2. MATERIALS

HOUSING: ALUMINUM

LEAVES: BLACK SPRING STEEL

LEVER: STEEL

**FOR INFORMATION ONLY:
DO NOT MANUFACTURE
PARTS TO THIS DRAWING**

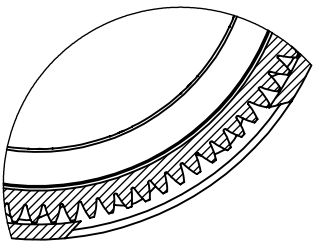
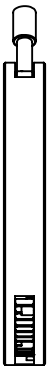
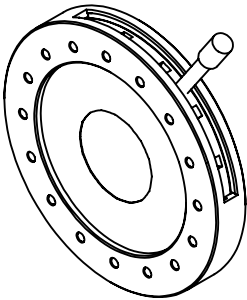
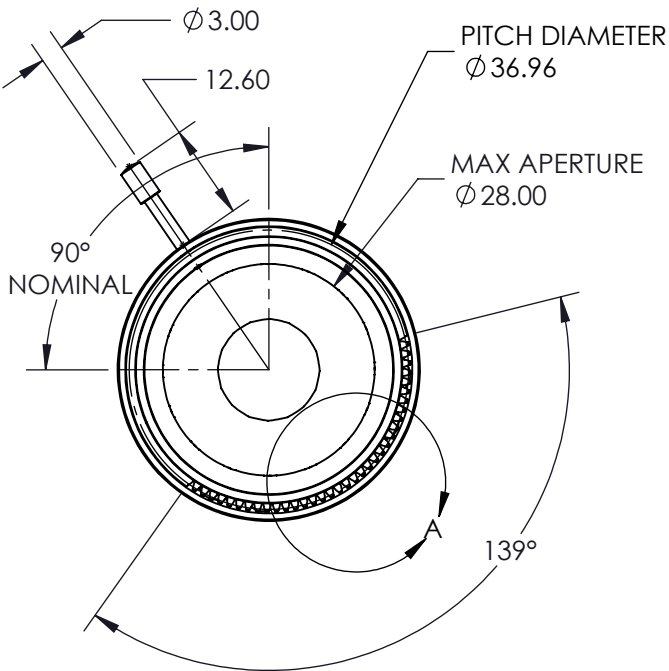
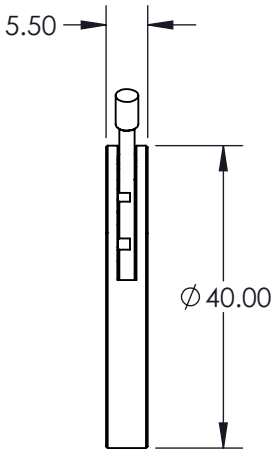

DETAIL A

SPECIFICATIONS SUBJECT TO CHANGE WITHOUT NOTICE
DIMENSIONS ARE FOR REFERENCE ONLY

EO® Edmund Optics®

REV. A	VALUE
MIN APERTURE	Ø1.50
GEAR WHEEL MODULE	0.4

THIRD ANGLE PROJECTION		TITLE	28mm MAX APERTURE AR MOTORIZABLE IRIS	
ALL DIMS IN	mm	DWG NO	24205	SHEET 1 OF 1