

NOTES:

- 1. SUBSTRATE: N-BK7
- 2. S2 TO BE PARALLEL WITH S1 TO <1 ARCMIN
- 3. COATING (APPLY ACROSS CLEAR APERTURE)

S1: NIR I (600-1050nm)  
S2: NIR I (600-1050nm)  
Ravg ≤0.5% @ 600 - 1050nm

4. FINE GRIND SURFACE

- 5. ROHS COMPLIANT

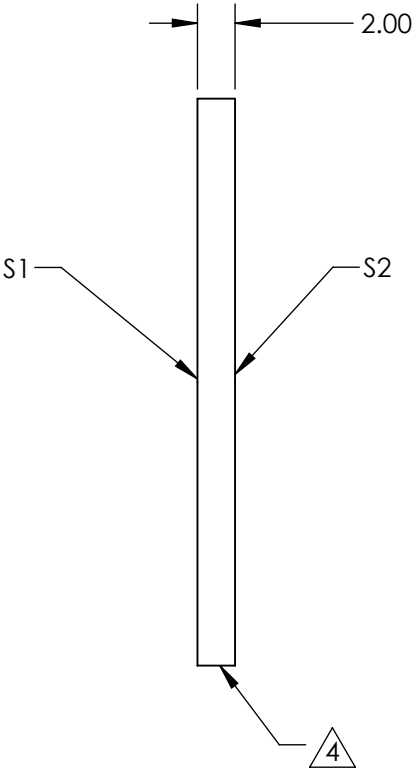
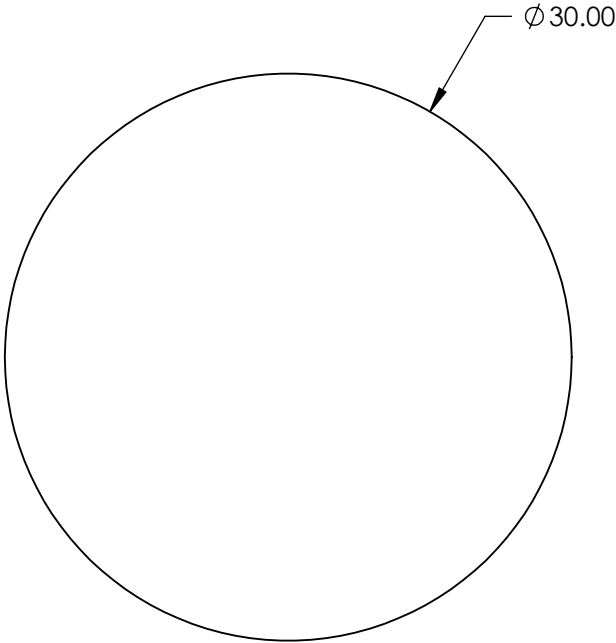

**FOR INFORMATION ONLY:**  
**DO NOT MANUFACTURE**  
**PARTS TO THIS DRAWING**

SPECIFICATIONS SUBJECT TO CHANGE WITHOUT NOTICE  
DIMENSIONS ARE FOR REFERENCE ONLY

	S1	S2
SHAPE	PLANO	PLANO
SURFACE QUALITY	60-40	60-40
CLEAR APERTURE	Ø 27.00	Ø 27.00
BEVEL	PROTECTED AS NEEDED	PROTECTED AS NEEDED



ALL DIMS IN mm

**Edmund Optics®**

TITLE

30mm Dia., 2mm Thick, NIR I Coated λ/4  
N-BK7 Window

DWG NO

23431

SHEET  
53 OF 84