

- NOTES:
- 1. SUBSTRATE: N-BK7
 - 2. S2 TO BE PARALLEL WITH S1 TO <1 ARCMIN
 - 3. COATING (APPLY ACROSS CLEAR APERTURE)

S1: NIR I (600-1050nm)
S2: NIR I (600-1050nm)
Ravg ≤0.5% @ 600 - 1050nm

4. FINE GRIND SURFACE

5. ROHS COMPLIANT

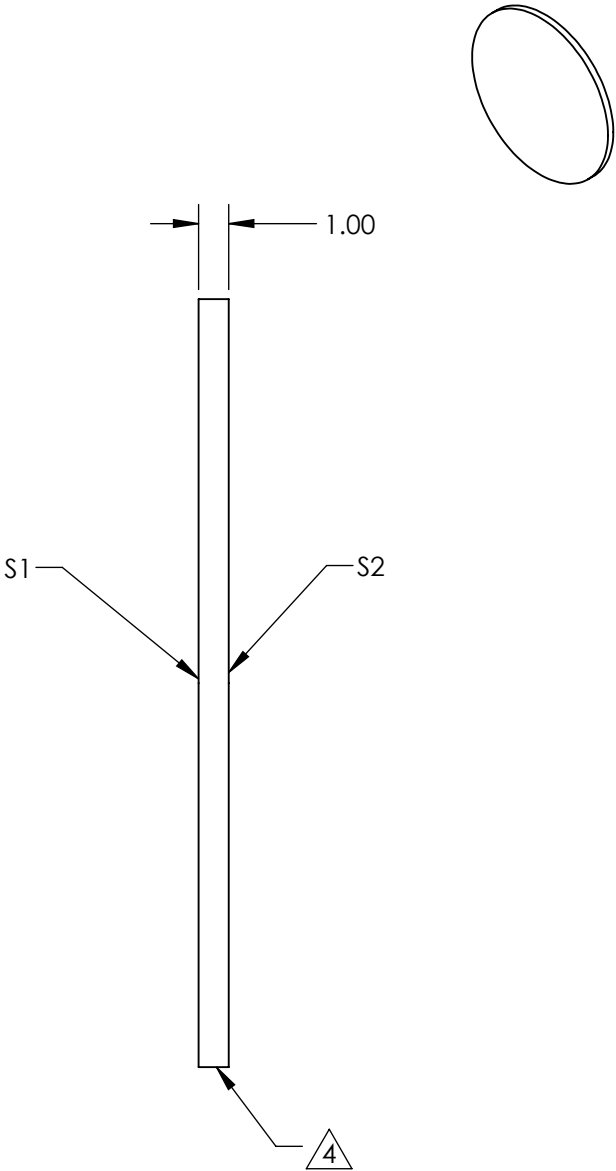
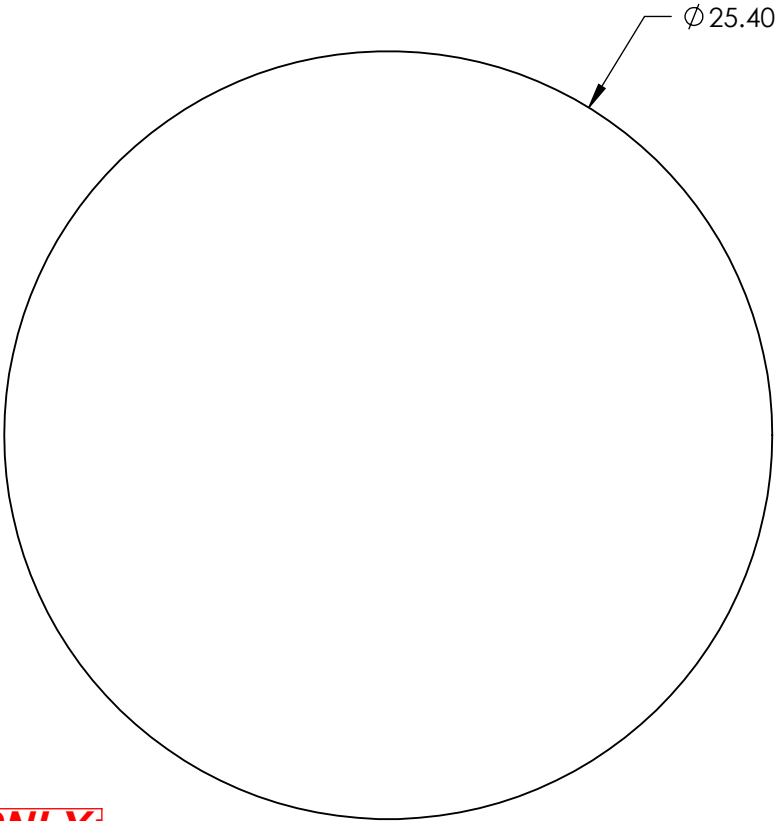

**FOR INFORMATION ONLY:
DO NOT MANUFACTURE
PARTS TO THIS DRAWING**

SPECIFICATIONS SUBJECT TO CHANGE WITHOUT NOTICE
DIMENSIONS ARE FOR REFERENCE ONLY

	S1	S2
SHAPE	PLANO	PLANO
SURFACE QUALITY	60-40	60-40
CLEAR APERTURE	$\phi 22.86$	$\phi 22.86$
BEVEL	PROTECTED AS NEEDED	PROTECTED AS NEEDED

THIRD ANGLE
PROJECTION

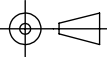

ALL DIMS IN

mm



Edmund Optics®

TITLE

25.4mm Dia., 1mm Thick, NIR I Coated $\lambda/4$
N-BK7 Window

DWG NO

23429

SHEET
51 OF 84