

NOTES:

- 1. SUBSTRATE: FUSED SILICA
- 2. SURFACE S2 TO BE PARALLEL WITH SURFACE S1 TO WITHIN <30 ARCSEC
- 3. COATING (APPLY ACROSS CLEAR APERTURE)

S1:R(AVG) ≥92% @ 190 - 250nm
R(AVG) ≥83% @ 250 - 900nm
S2: COMMERCIAL POLISH

4. S2 & EDGES FINE GRIND SURFACE

5. POWER, IRREGULARITY, AND SURFACE QUALITY SPECIFICATION APPLY ACROSS CLEAR APERTURE

6. ROHS COMPLIANT

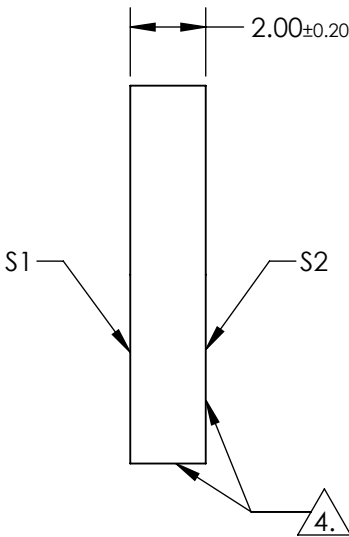
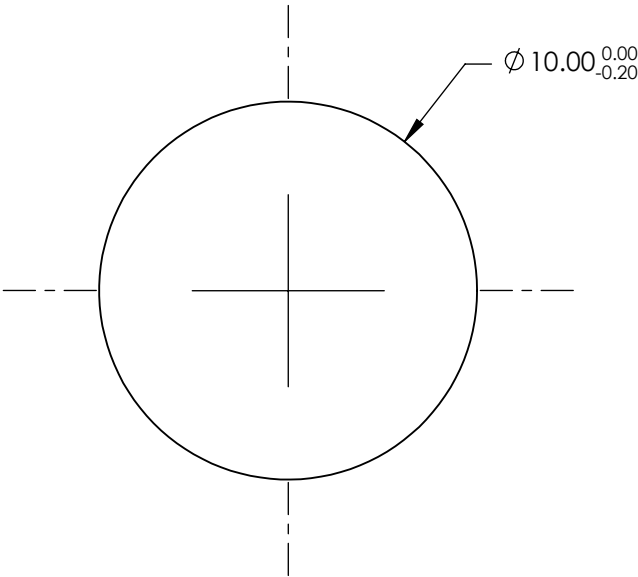

**FOR INFORMATION ONLY:
DO NOT MANUFACTURE
PARTS TO THIS DRAWING**

SPECIFICATIONS SUBJECT TO CHANGE WITHOUT NOTICE
DIMENSIONS ARE FOR REFERENCE ONLY

	S1	S2
SHAPE	PLANO	PLANO
SURFACE QUALITY	20-10	N/A
SURFACE FLATNESS	λ/10	N/A
COATING TYPE	METAL	N/A
COATING	ENHANCED ALUMINUM (190-900nm)	N/A
BEVEL	PROTECTED AS NEEDED	PROTECTED AS NEEDED



ALL DIMS IN mm

Edmund Optics®

TITLE	10mm Dia., Enhanced Deep UV (DUV) Mirror		
DWG NO	18740	SHEET 1 OF 1	