

NOTES:

1. SUBSTRATE: POLYMER FILM XP42-75
2. OPERATING TEMPERATURE: -40 TO +80
3. WAVELENGTH RANGE: 400 - 700 nm
4. POLARIZATION: >99.98
5. TRANSMISSION (%):
SINGLE: 42 ±2
PARALLEL: 36.4
CROSSED: <0.004
6. ROHS COMPLIANT

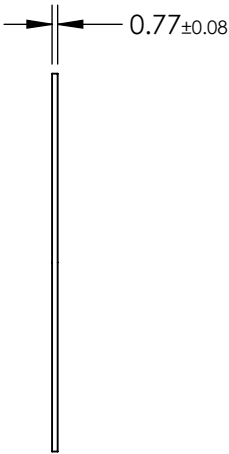
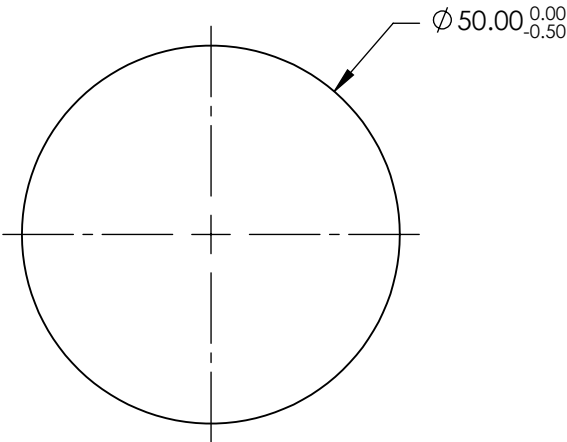
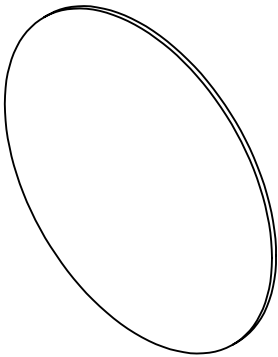

FOR INFORMATION ONLY:
DO NOT MANUFACTURE
PARTS TO THIS DRAWING

SPECIFICATIONS SUBJECT TO CHANGE WITHOUT NOTICE
DIMENSIONS ARE FOR REFERENCE ONLY

 **Edmund Optics®**

THIRD ANGLE PROJECTION 		TITLE	50mm Dia. Linear Polarizing Film (XP42-75)	
ALL DIMS IN	mm	DWG NO	19017	SHEET 1 OF 1