

NOTES:

1. SUBSTRATE: N-SF5

2. COATING (APPLY ACROSS CLEAR APERTURE)

S1 & S2: SWIR+ (900-1700nm)

R(AVG) <0.5% @ 900 - 1700nm @ ±30° AOI

R(ABS) <1% @ 900 - 1700nm @ ±30° AOI

3. EDGES: FINE GROUND

4. CENTERING: <3 ARCMIN

5. ASPHERE FIGURE ERROR: 0.25µm RMS

6. ASPHERIC SURFACE DESCRIBED BY (REF. COEFFICIENT TABLE)

$$Z_{ASPH}(Y) = \frac{(\frac{1}{RADIUS})^2 Y^2}{1 + \sqrt{1 - (1+k) * (\frac{1}{RADIUS})^2 Y^2}} + D * Y^2 + E * Y^4 + F * Y^6 + G * Y^8 + H * Y^{10} + J * Y^{12} + L * Y^{14}$$

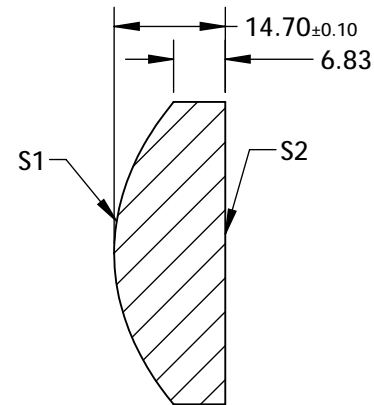
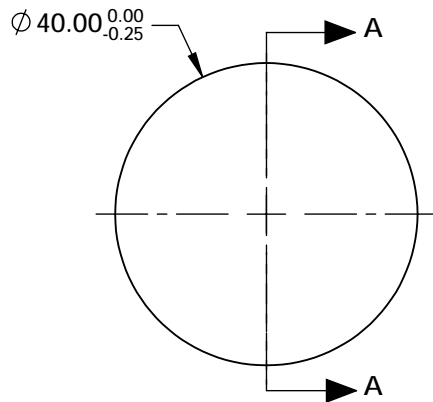

SECTION A-A

COEFFICIENT TABLE 6.

| COEFFICIENT | S1 |
|---------------|---------------|
| SEMI-DIAMETER | 1.500000E+01 |
| (1/RADIUS) | 3.716091E-02 |
| k | -7.633170E-01 |
| D | 0.000000E+00 |
| E | 1.130400E-06 |
| F | 2.028051E-10 |
| G | -9.363066E-13 |
| H | 1.944793E-15 |
| J | -3.345788E-18 |
| L | 2.852466E-21 |

SPECIFICATIONS SUBJECT TO CHANGE WITHOUT NOTICE DIMENSIONS ARE FOR REFERENCE ONLY

| | | | | | | | |
|-----------------|----------------------|----------------------|--|-------|---|--|--|
| | S1 | S2 | EFL @ 587.6nm | 40 |  Edmund Optics® | | |
| SHAPE | CONVEX | PLANO | BFL @ 587.6nm | 31.21 | | | |
| RADIUS | 26.910 | INFINITY | THIRD ANGLE PROJECTION  | | TITLE 40mm Dia., 0.50 Numerical Aperture, 900-1700nm Coated, Precision Aspheric Lens | | |
| SURFACE QUALITY | 40-20 | 40-20 | | | | | |
| CLEAR APERTURE | Ø39 | Ø39 | ALL DIMS IN mm | | DWG NO 17008 | | |
| BEVEL MAX | PROTECTIVE AS NEEDED | PROTECTIVE AS NEEDED | | | | | |
| | | | | | SHEET 1 OF 1 | | |

**FOR INFORMATION ONLY:
DO NOT MANUFACTURE
PARTS TO THIS DRAWING**