

NOTES:

- 1. SUBSTRATE:  
N-BK7
- 2. S2 TO BE PARALLEL WITH S1 TO <1 ARCMIN
- 3. COATING (APPLY ACROSS CLEAR APERTURE)  
S1 & S2: NONE
- 4. FINE GRIND SURFACE
- 5. RoHS COMPLIANT
- 6. SURFACE FLATNESS (P-V):  
 $\lambda/4$  (per inch over clear aperture)

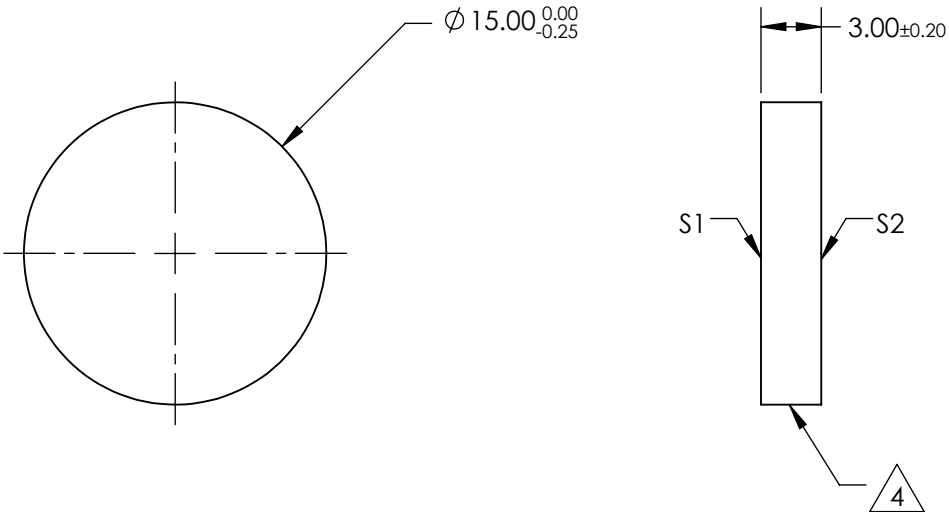
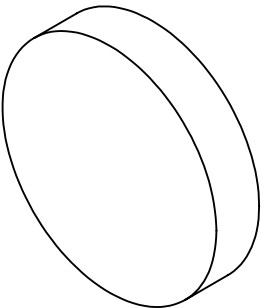

**FOR INFORMATION ONLY:  
DO NOT MANUFACTURE  
PARTS TO THIS DRAWING**

SPECIFICATIONS SUBJECT TO CHANGE WITHOUT NOTICE  
DIMENSIONS ARE FOR REFERENCE ONLY

**Edmund Optics®**

|                 | S1                   | S2                   |
|-----------------|----------------------|----------------------|
| SHAPE           | PLANO                | PLANO                |
| SURFACE QUALITY | 60-40                | 60-40                |
| CLEAR APERTURE  | Ø13.50               | Ø13.50               |
| BEVEL           | PROTECTIVE AS NEEDED | PROTECTIVE AS NEEDED |



ALL DIMS IN

mm

TITLE

15mm DIA., 3mm THICK, UNCOATED  $\lambda/4$  N-BK7 WINDOW

DWG NO

45575

SHEET  
1 OF 1