

NOTES:

1. SUBSTRATE MATERIAL:  
BOROFLOAT®
2. COATING (APPLY ACROSS CLEAR APERTURE)  
  
S1: NONE  
S2: NONE
3. POWER, IRREGULARITY, SURFACE QUALITY, AND COATING  
SPECIFICATIONS APPLY ACROSS CLEAR APERTURE
4.

FINE GROUND SURFACE
5. ROHS COMPLIANT

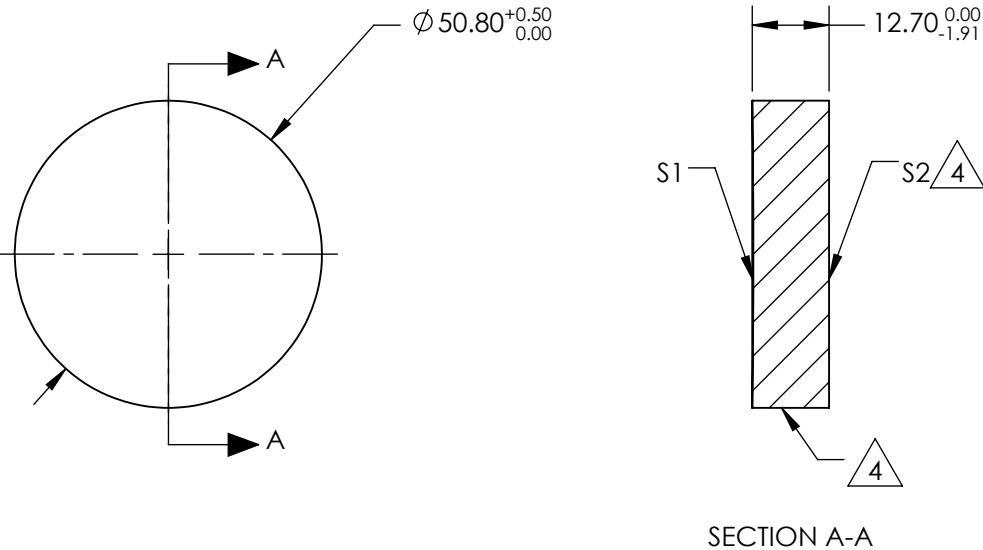

**FOR INFORMATION ONLY:  
DO NOT MANUFACTURE  
PARTS TO THIS DRAWING**

SPECIFICATIONS SUBJECT TO CHANGE WITHOUT NOTICE  
DIMENSIONS ARE FOR REFERENCE ONLY

REV. A	S1	S2	DIMENSIONS ARE FOR REFERENCE ONLY				
SHAPE	CONCAVE	PLANO	<div><div><div><div></div><div></div></div><div><div></div><div></div></div></div><div><div></div><div></div></div><div>Edmund Optics®</div></div>				
EFFECTIVE FOCAL LENGTH	1016mm	N/A					
FOCAL LENGTH TOLERANCE	±2%	N/A					
APERTURE	f/20	N/A					
SURFACE QUALITY	60-40	60-40	<div>THIRD ANGLE PROJECTION</div> <div><div><div></div><div></div></div><div><div></div><div></div></div></div>	TITLE	2" Dia, 40" FL Protected Alum., Spherical Mirror		
SURFACE FLATNESS	λ/4	λ/4		ALL DIMS IN	mm	DWG NO	43348
BEVEL	PROTECTIVE AS NEEDED	PROTECTIVE AS NEEDED					