

**FOR INFORMATION ONLY:
DO NOT MANUFACTURE
PARTS TO THIS DRAWING**

- NOTES:
- SUBSTRATE
 - SURFACE S2 TO BE PARALLEL WITH SURFACE S1 TO WITHIN ± 3 arcsec
 - COATING (APPLY ACROSS COATING APERTURE)
DURABILITY:
PERFORMANCE SPECIFICATIONS:
T(avg): $>85\%$ @ 0° AOI FROM 400 - 725nm
T(avg): $<1\%$ @ 0° AOI FROM 800 - 990nm
T(avg): $\approx 50\%$ FOR 0° AOI @ 750nm $\pm 2\%$

S2: SINGLE LAYER MgF2

-  FINE GRIND SURFACE
- POWER, IRREGULARITY, AND SURFACE QUALITY SPECIFICATIONS
APPLY ACROSS CLEAR APERTURE
 - TRANSMITTED WAVEFRONT DISTORTION P-V @ 632.8nm 1/10 λ
 - ROHS COMPLIANT

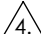
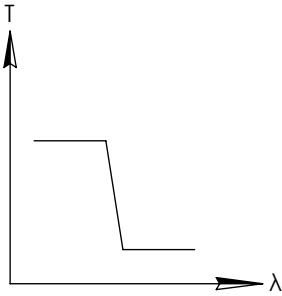
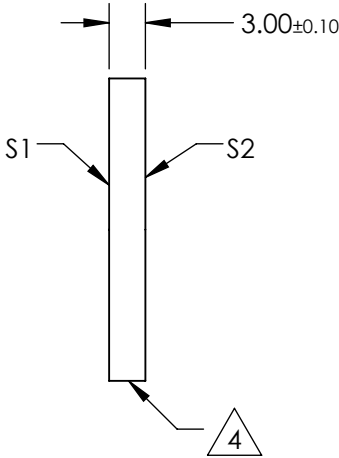
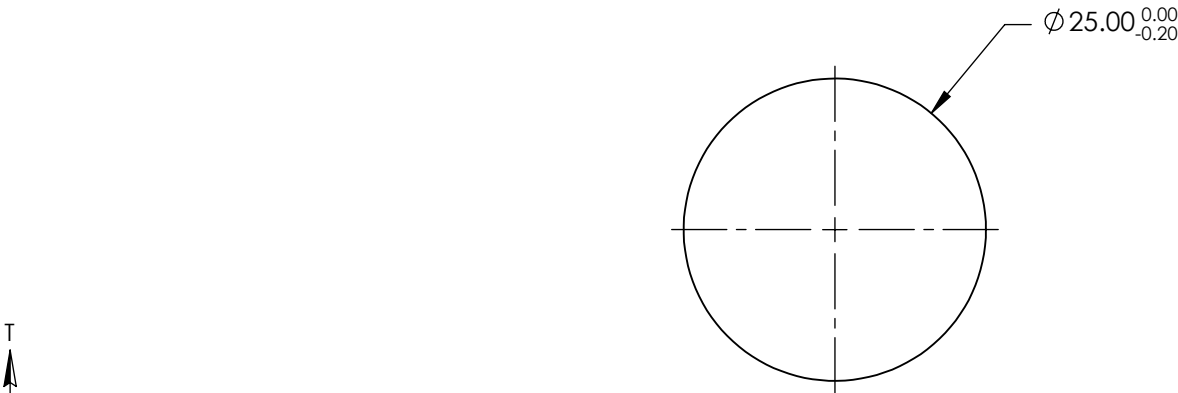
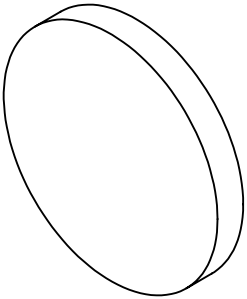

SHORTPASS FILTER

SPECIFICATIONS SUBJECT TO CHANGE WITHOUT NOTICE
DIMENSIONS ARE FOR REFERENCE ONLY

Rev. A	S1	S2
SHAPE	PLANO	PLANO
SURFACE QUALITY	40-20	40-20
CLEAR APERTURE	80%	80%
BEVEL	PROTECTIVE AS NEEDED	PROTECTIVE AS NEEDED



ALL DIMS IN mm

 **Edmund Optics®**

TITLE OD2, Ø25mm, 750nm, SHORTPASS FILTER

DWG NO 47585

SHEET
1 OF 1